

Instructions for Use

Follow current department protocols regarding intradermal procedures.

Vaccination Technique



Verify that Qfix ink align package is completely sealed and unopened.

Remove Qfix ink align device from packaging. **Hold down on cap and shake firmly.**



Remove and discard plastic cap.



Attach a sterile needle to Qfix ink align device. Best results are achieved with Short Stem 21 gauge needle. Hold Qfix ink align at ink bulb between thumb and index finger. Over trash receptacle, squeeze to produce ink drops from needle tip.



With free hand, hold patient's skin taut over tattoo point. Gently insert needle point (lumen) under skin surface.

Carefully squeeze ink bulb, visualize ink collection at skin surface, and remove needle.



Dispose needle as per hospital/facility regulations. Dispose Qfix ink align product in normal trash. Dispose Qfix ink align cartridge in trash.

Dropping Technique

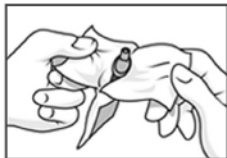

Verify that Qfix ink align package is completely sealed and unopened.

Remove Qfix ink align device from packaging. **Hold down on cap and shake firmly.**

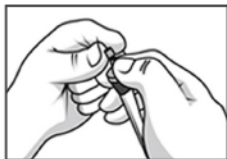

Remove and discard plastic cap.



Hold Qfix ink align bulb between thumb and index finger. Over trash receptacle, squeeze to produce ink drops from tip.



Gently insert sterilized needle point (lumen) under skin surface.

Carefully squeeze ink bulb, dripping ink onto needle tip. Twist needle and remove.



Dispose needle as per hospital/facility regulations. Dispose Qfix ink product in normal trash. Dispose Qfix ink align cartridge in trash.

*For a slightly larger tattoo, gently twist needle after introducing ink.

Cleaning Instructions: Use soap and water to wipe up spills.

Rx Statement: United States Federal law restricts this device to sale by or on the order of a physician.